

# TECHNICAL DATA

SINGLE DIRECTION VIBRATORY PLATES

BVP 10/30, BVP 12/50 A



## Handling

47 kg lightweight (BVP10/30)  
72 kg lightweight (BVP12/50A)



## Performance

Fast running and simple handling



## Costs

Maintenance free exciter (BVP10/30)

**Shipping dimensions in m3**

|                    |       |
|--------------------|-------|
| <b>BVP 10/30</b>   | 0,111 |
| <b>BVP 12/50 A</b> | 0,251 |

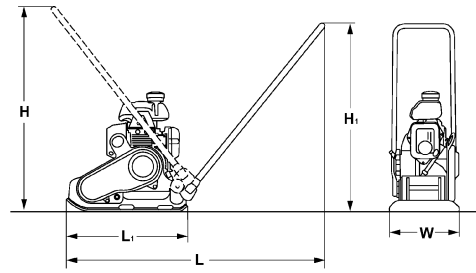

**Standard Equipment**

- Vibration insulated steering bow
- Detachable steering handle
- Highly wear resistant base plate (BVP10/30)
- Highly wear resistant cast iron base plate (BVP12/50A)
- Automatic shutdown at low oil level
- Recoil starter
- Single point lifting device
- Fully protected V-belt
- Carrying handles
- 3-2-1 Warranty
- Sprinkler system (BVP12/50A)

**Optional Equipment**

- Special painting
- Plastic mat (BVP10/30)
- Service Kit
- TOUGH WARRANTY (BVP12/50A)
- Comfort guide handle (BVP10/30)

**Dimensions in mm**

|                    | H   | H1  | L    | L1  | W   |
|--------------------|-----|-----|------|-----|-----|
| <b>BVP 10/30</b>   | 489 | 840 | 1058 | 509 | 300 |
| <b>BVP 12/50 A</b> | 660 | 890 | 970  | 530 | 500 |

**Technical Data**

**Weights**

|                             |    |    |
|-----------------------------|----|----|
| Operating weight CECE ..... | kg | 47 |
| Basic weight .....          | kg | 46 |

**Dimensions**

|                     |    |     |     |
|---------------------|----|-----|-----|
| Working width ..... | mm | 300 | 500 |
|---------------------|----|-----|-----|

**Driving Characteristics**

|   |       |    |    |
|---|-------|----|----|
| Working speed, max. ....                    | m/min | 25 | 25 |
| Max. gradeability (dep. on soil con.) ..... | %     | 30 | 30 |

**Drive**

|  |       |                |                |
|--|-------|----------------|----------------|
| Engine manufacturer .....                  |       | Honda          | Honda          |
| Type .....                                 |       | GX 100         | GX 120         |
| Emission stage .....                       |       | CARB Phase III | CARB Phase III |
| Cooling .....                              |       | air            | air            |
| Number of cylinders .....                  |       | 1              | 1              |
| Performance SAE J 1349 .....               | kW    | 2,1            | 2,9            |
| Speed .....                                | min-1 | 3.600          | 3.600          |
| Drive system .....                         |       | mech.          | mech.          |
| Fuel .....                                 |       | gasoline       | gasoline       |
| Fuel consump. aver. during operation ..... | l/h   | 0,6            | 0,9            |

**Exciter system**

|                         |    |      |      |
|-------------------------|----|------|------|
| Frequency .....         | Hz | 100  | 94   |
| Centrifugal force ..... | kN | 10   | 12   |
| Amplitude .....         | mm | 1,34 | 1,10 |

**Capacities**

|             |   |     |     |
|-------------|---|-----|-----|
| Fuel .....  | l | 0,8 | 2,0 |
| Water ..... | l | -   | 7,0 |

Technical modifications reserved. Machines may be shown with options.



PRE 834 19 010

060317 Sa01

**BOMAG**  
 Hellerwald  
 D-56154 Boppard  
 P.O. Box 5162  
 Tel. (0)6742 - 1000  
 Fax (0)6742 - 3090

